

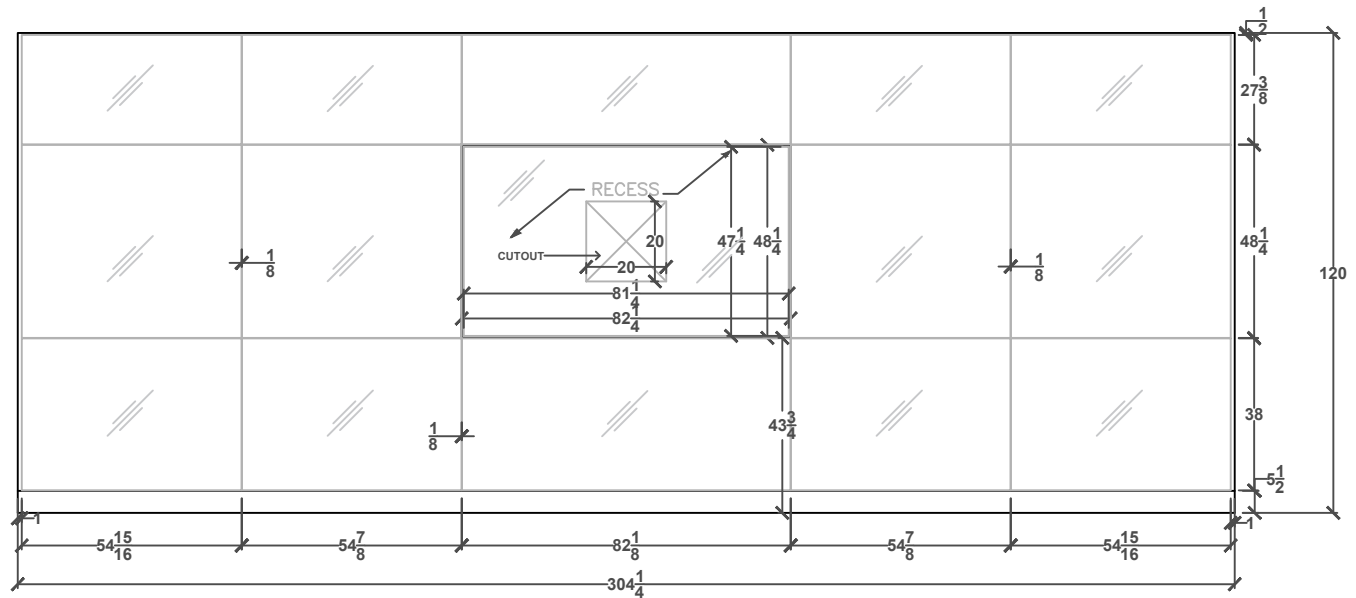

Visual Presentation Drawings

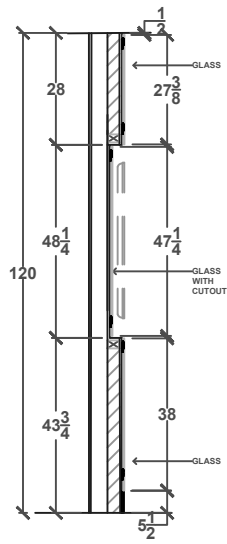

NORTH

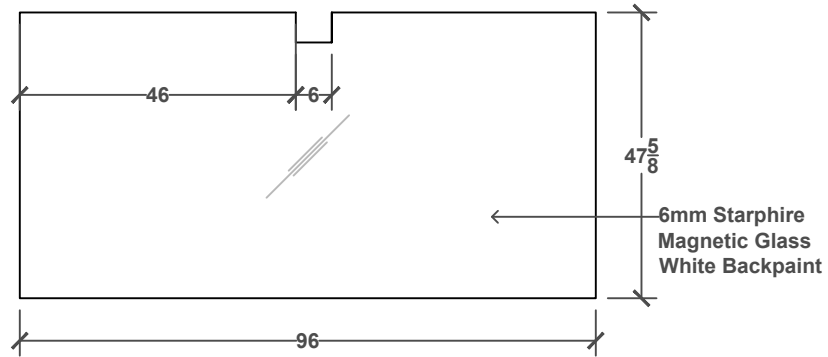

1 Elevation - Custom Magnetic Glassboard
3/8" = 1'-0"

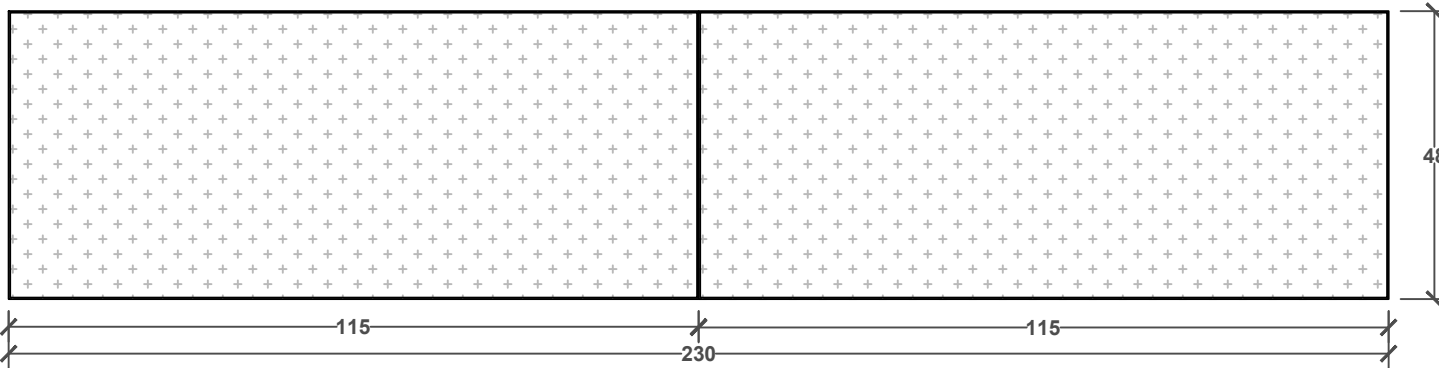

2 Elevation - Elements Series Noticeboards - Grade 2 Fabric
3/8" = 1'-0"

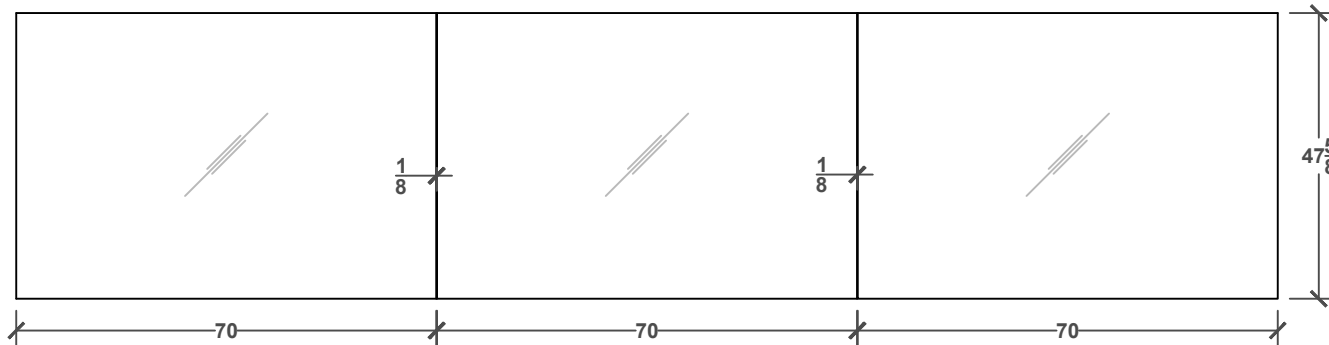

3 Elevation - Custom Magnetic Glassboards
3/8" = 1'-0"

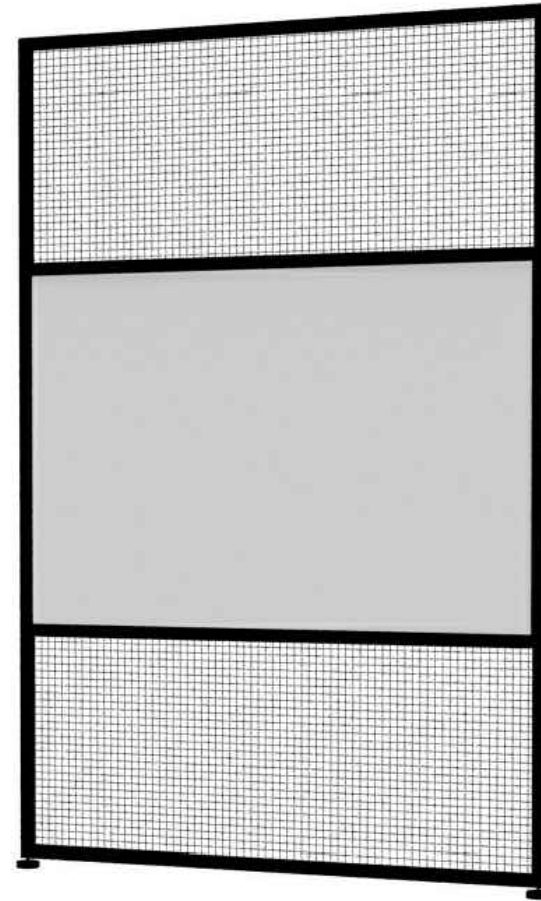
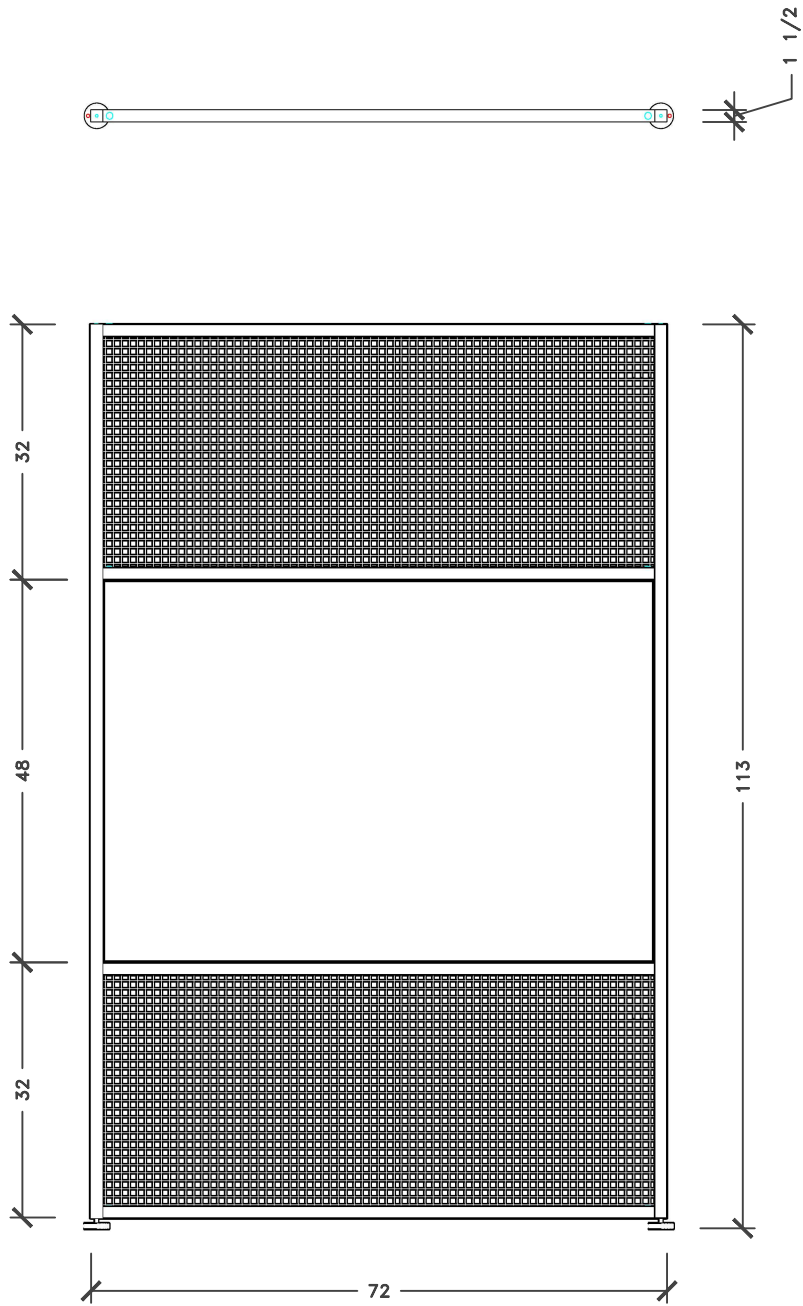

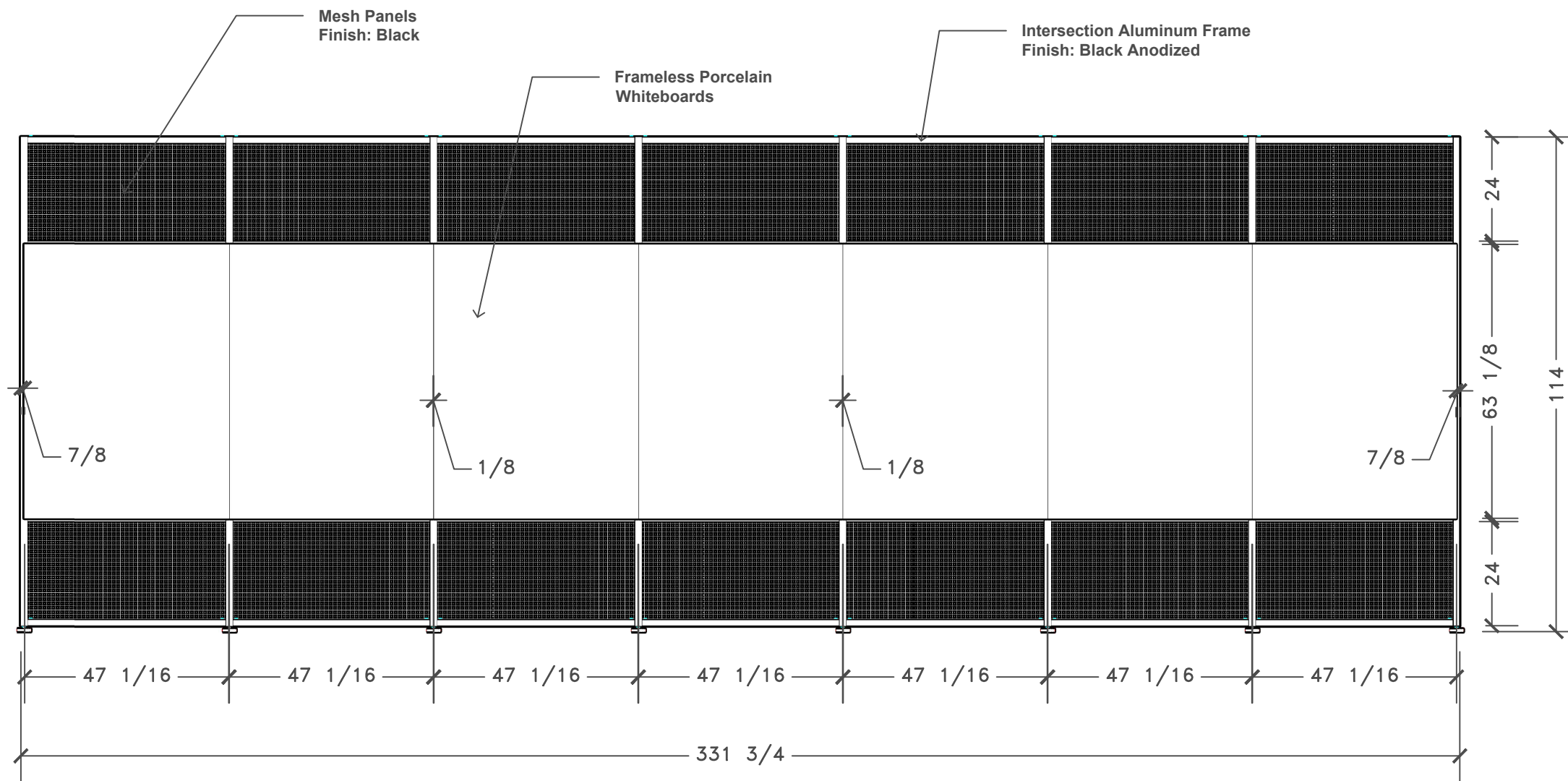

1 Front Elevation - Custom Intersection Divider with Frameless Whiteboards
3/8" = 1'-0" Qty. 2

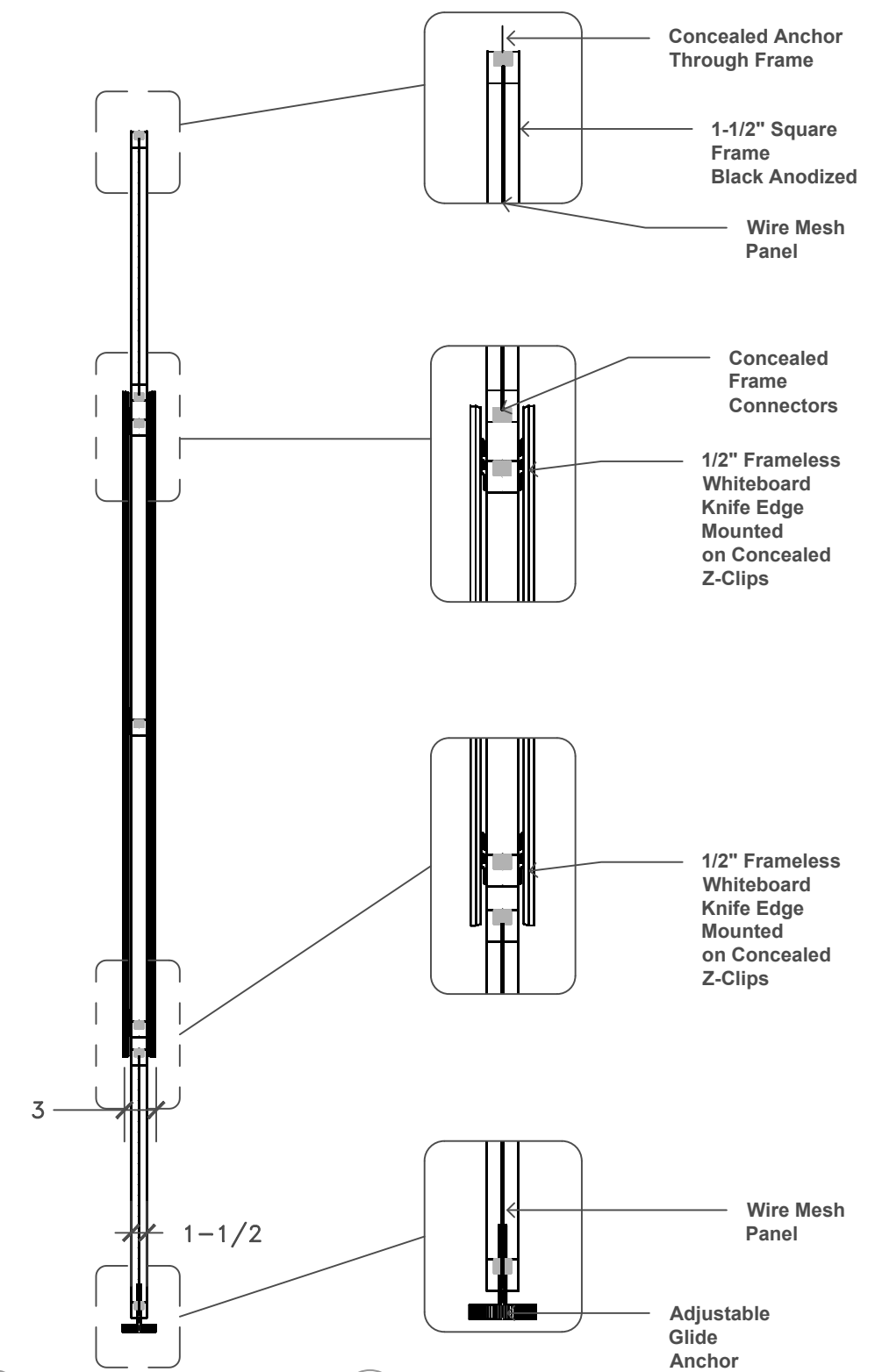

2 Section
3/4" = 1'-0"

3 Enlarged Detail
1 1/2" = 1'-0"

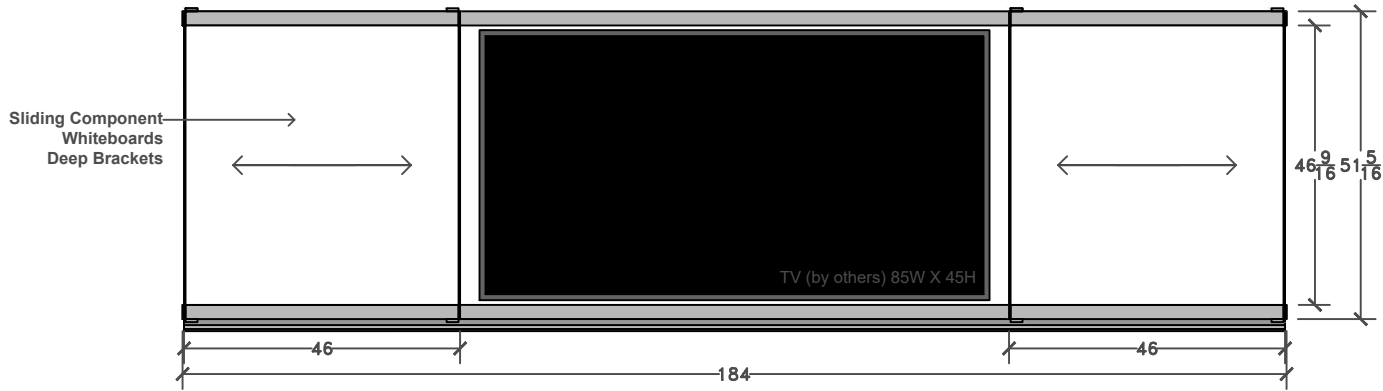

1 Elevation - VIP Media Wall Rail with (2) Sliding Component Whiteboards - Opened
 3/8" = 1'-0"

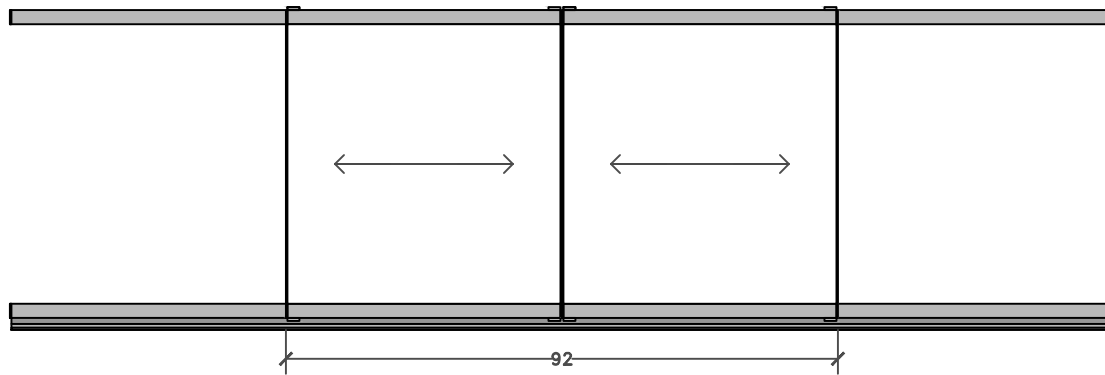

2 Elevation - VIP Media Wall Rail with (2) Sliding Component Whiteboards - Closed
 3/8" = 1'-0"

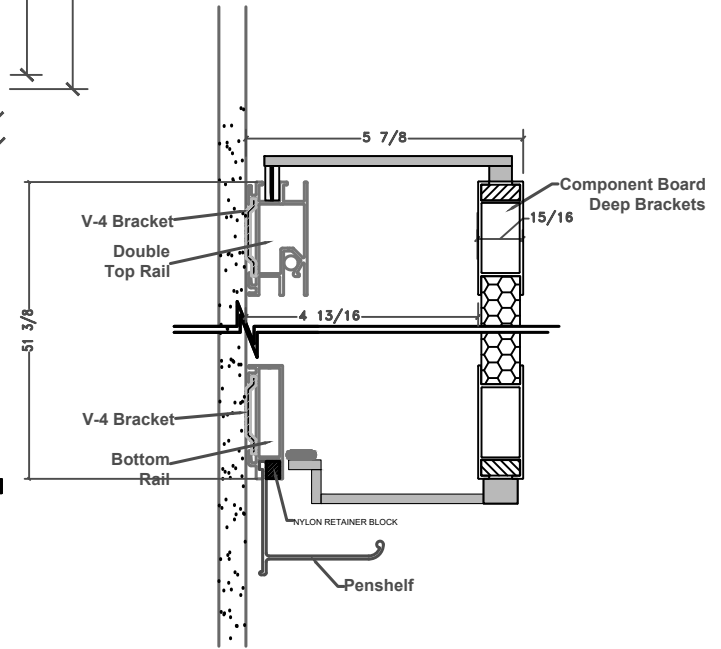

3 Section
 3" = 1'-0"

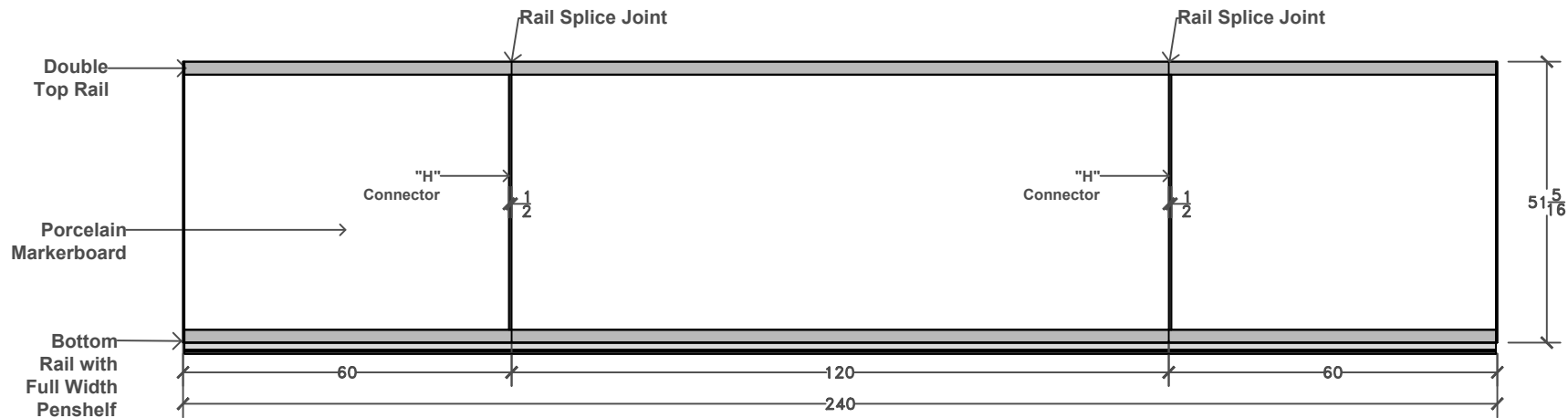

1a Elevation - VIP Double Track Porcelain Markerboard - Shown Without Sliding Markerboards
 3/8" = 1'-0"

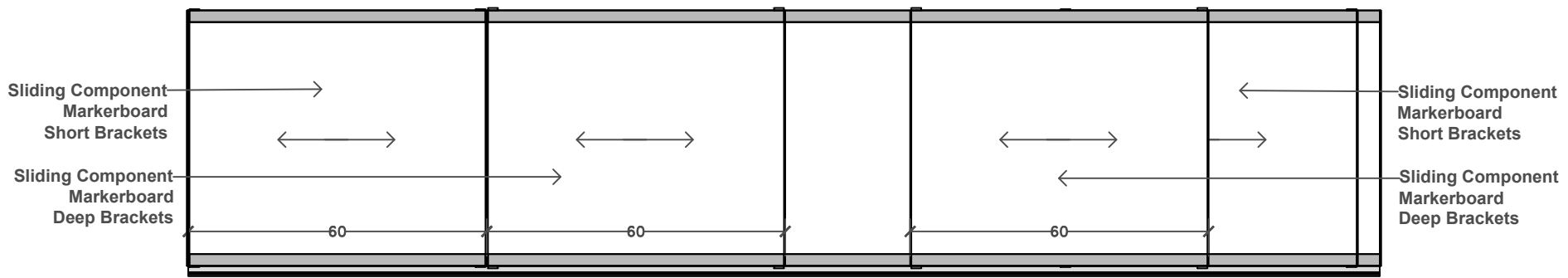

1b Elevation - VIP Double Track Porcelain Markerboard - With Sliding Markerboards
 3/8" = 1'-0"

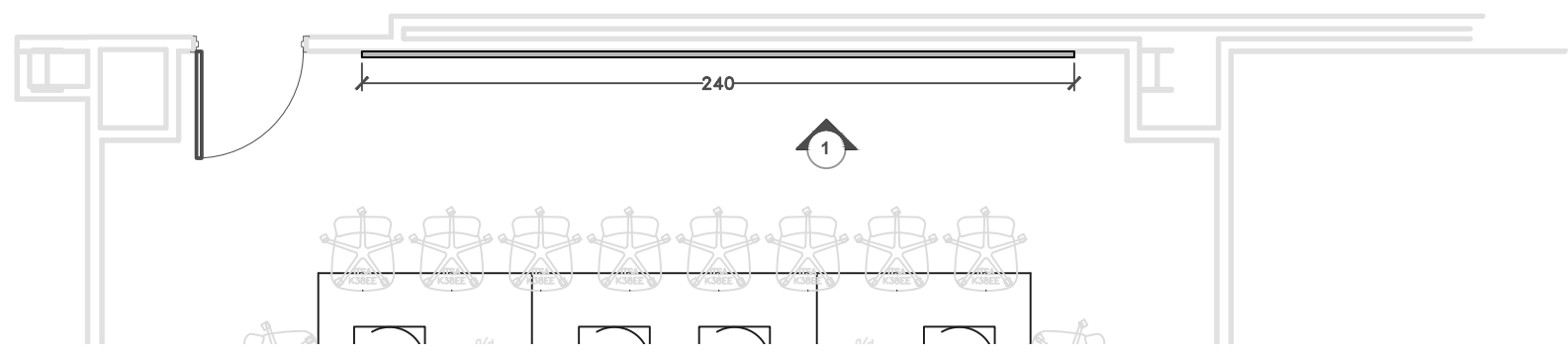

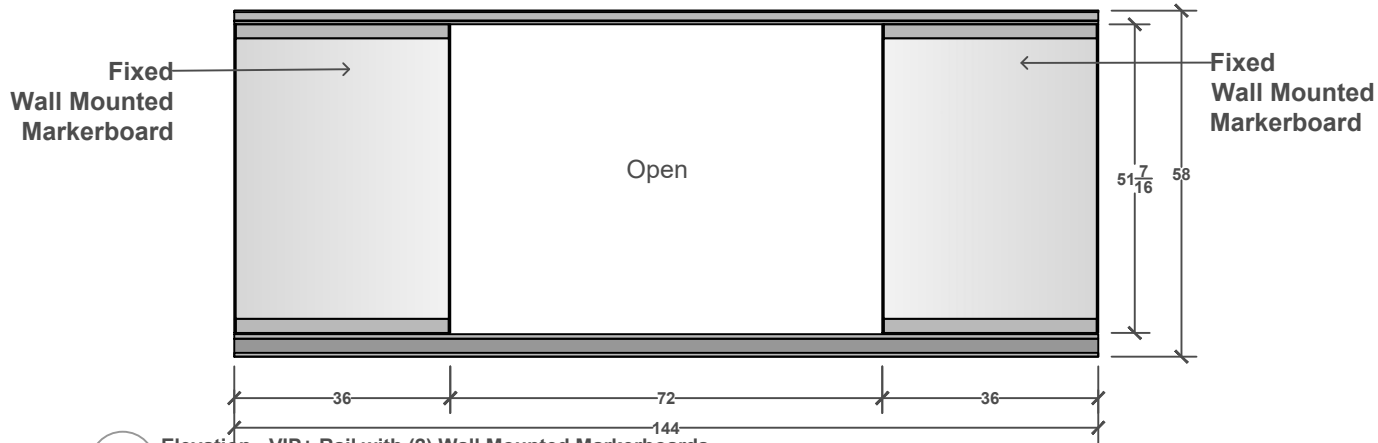

1 Elevation - VIP+ Rail with (2) Wall Mounted Markerboards
3/8" = 1'-0"

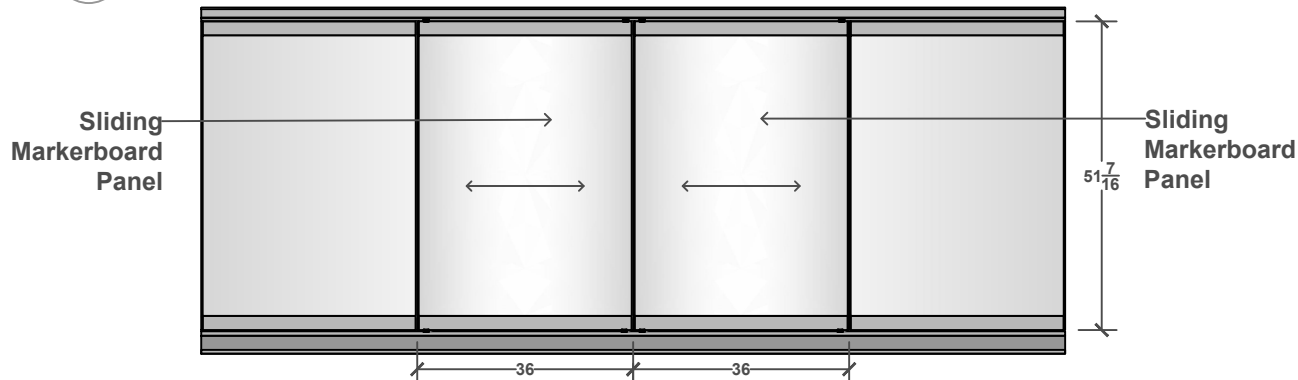

2 Elevation - VIP+ Rail with (2) Wall Mounted Markerboards and (2) Sliding Markerboards - Closed
3/8" = 1'-0"

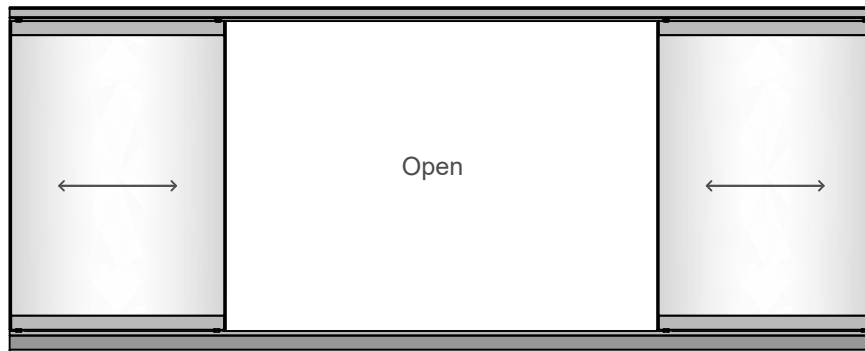

3 Elevation - VIP+ Rail with (2) Wall Mounted Markerboards and (2) Sliding Markerboards - Opened
3/8" = 1'-0"

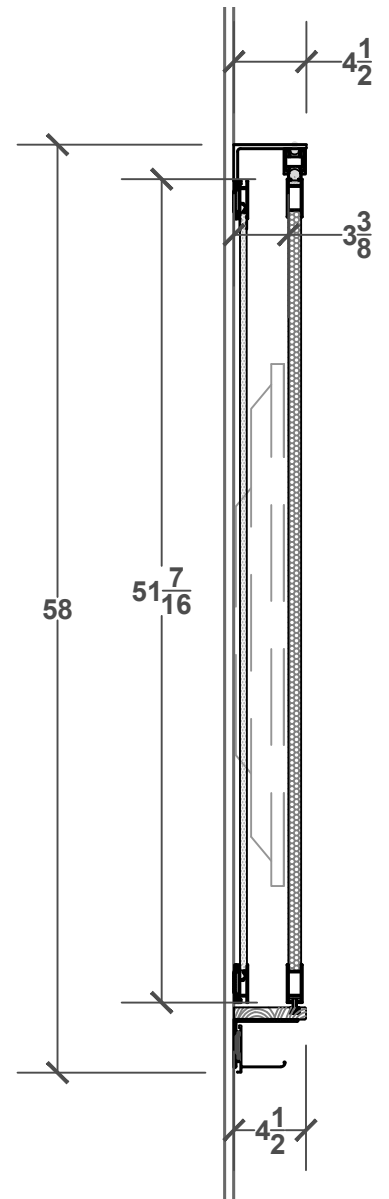

4 Enlarged Section
1" = 1'-0"

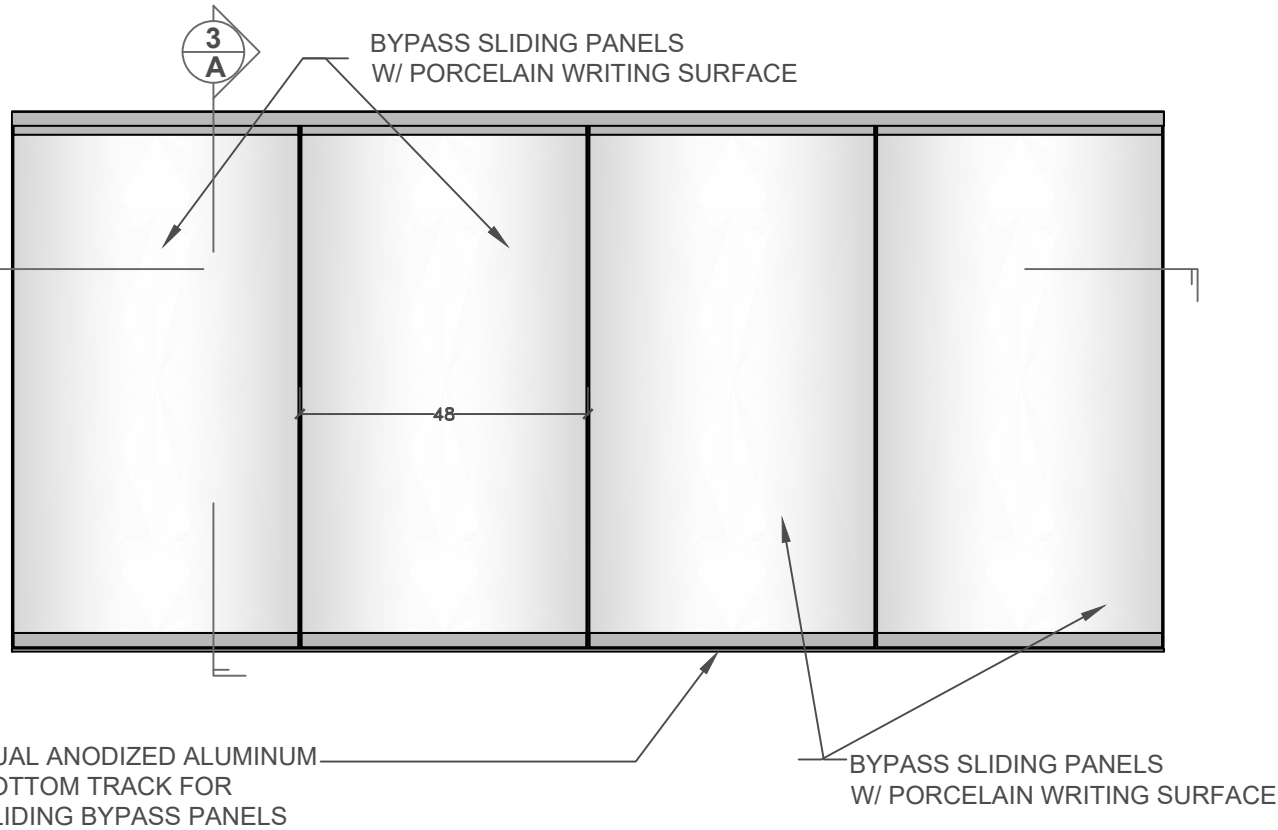

1
A **ELEVATION - VIP+ SLIDING MARKERBOARD SYSTEM**
3/8" = 1'-0"

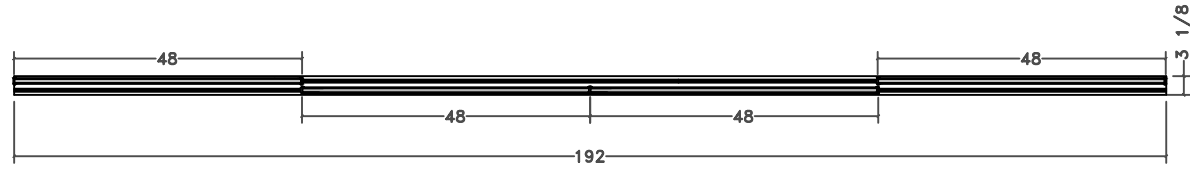

2
A **SECTION**
3/8" = 1'-0"

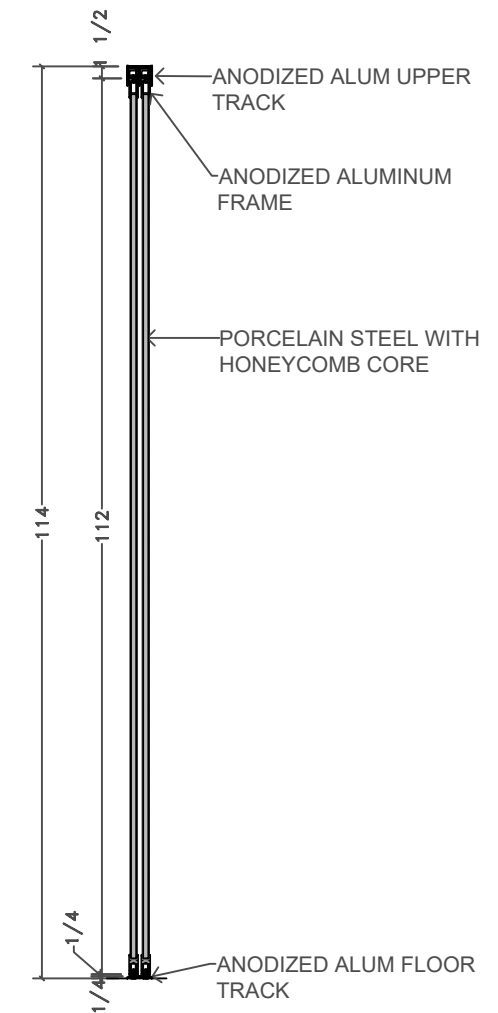

3
A **SECTION**
1/2" = 1'-0"



where custom is standard

205.941.1942

Birmingham, AL

info@coronagroupinc.com

coronagroupinc.com